

Model No :: **20030LEDDMGLP-BRZ/RFR**
Name :: Bermuda



Project Name :: _____
Location :: _____
Type :: _____
Quantity :: _____
Notes :: _____

Product Information

Product ID :: 20030
UPC Code :: 6.41594E+11
Mounting Type :: Wall
Finish :: Bronze
Diffuser :: Ribbed Frosted
Alt. Finishes :: Bronze (BRZ); Satin (SAT)
Alt. Diffusers :: Ribbed Frosted (RFR)

Product Dimensions

Fixture	Canopy
Length ::	Length :: 7
Width :: 6	Width :: 4.5
Diameter ::	Diameter ::
Extension :: 5.5	Height :: 0.5
Height :: 16.75	
Overall Height ::	

Technical Specifications

Qualifications

Location Rating :: Wet
Certification :: UL Listed (US/Canada)
IES File ::
JA8 Compliant :: Yes
Energy Star :: No
ADA Compliant :: No
Marine Grade :: Yes
Emergency Lighting :: No
Warranty :: 3 Year Limited

Specifications

Frame Material :: Aluminum
Diffuser Material :: Glass
Voltage :: 120v
Lamping Type :: A-19 (RLED)
Lamping Base :: E-26
Lamp Quantity :: 2
Lamp Wattage :: 10 W
Total Wattage :: 20 W
Lamps Included :: Yes
J-Box Type :: Standard

Photometrics

CCT :: 3000 K
CRI :: 90
Wattage :: 20 W
Nominal Lumens :: 1600
Delivered Lumens :: 0

Recommended Dimmers

(ELV) LUTRON Skylark SELV-300P; (MLV) COOPER Aspire 9530SW; (TRIAC) LEGRAND Titan CD703-PW

Additional Items :: 0

Line Drawing #1

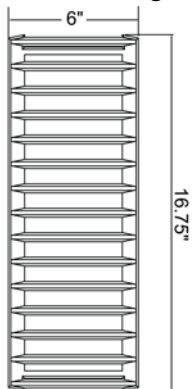

Line Drawing #2

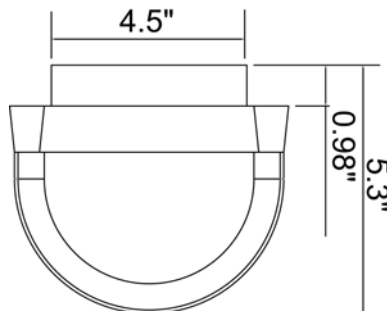

IES File

Image Not Available

Toll Free 800-828-5483 • www.AccessLighting.com

14410 Myford Road, Irvine, CA 92606

The information provided is subject to change without notice. ©2020 Access Lighting Corporation. All Rights Reserved
Rev. 202105 Filename:: 20030LEDDMGLP-BRZ_RFR.pdf

