

Model No :: **31010-BS/OPL**
Name :: Geneva



Project Name :: _____
Location :: _____
Type :: _____
Quantity :: _____
Notes :: _____

Product Information

Product ID :: 31010
UPC Code :: 6.41594E+11
Mounting Type :: Wall
Finish :: Brushed Steel
Diffuser :: Opal
Alt. Finishes :: Brushed Steel (BS)
Alt. Diffusers :: Opal (OPL)

Product Dimensions

Fixture	Canopy
Length ::	Length :: 24.5
Width :: 24.5	Width :: 2.25
Diameter ::	Diameter ::
Extension :: 3.5	Height :: 1.25
Height :: 4	
Overall Height ::	

Technical Specifications

Qualifications

Location Rating :: Damp
Certification :: ETL Listed (US/Canada)
IES File ::
JA8 Compliant :: No
Energy Star :: No
ADA Compliant :: Yes
Marine Grade :: No
Emergency Lighting :: No
Warranty :: 1 Year Limited

Specifications

Frame Material :: Metal
Diffuser Material :: Glass
Voltage :: 120v
Lamping Type :: T-5 HO (FL)
Lamping Base :: Bi-Pin
Lamp Quantity :: 1
Lamp Wattage :: 24 W
Total Wattage :: 24 W
Lamps Included :: Yes
J-Box Type :: Standard

Photometrics

CCT :: 3000 K
CRI :: 0
Wattage :: 24 W
Nominal Lumens :: 1750
Delivered Lumens :: 0

Recommended Dimmers

0

Additional Items :: 0

Line Drawing #1

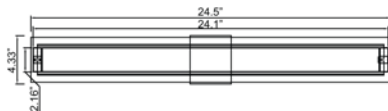

Line Drawing #2

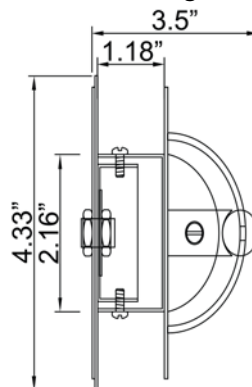

IES File

Image Not Available

Toll Free 800-828-5483 • www.AccessLighting.com

14410 Myford Road, Irvine, CA 92606

The information provided is subject to change without notice. ©2020 Access Lighting Corporation. All Rights Reserved
Rev. 202105 Filename:: 31010-BS_OPL.pdf

