

INSTALLATION INSTRUCTIONS HTL-RGBW-5MKIT



⚠ WARNING

These products may represent a possible shock or fire hazard if improperly installed or attached in any way. Products should be installed in accordance with these instructions, current electrical codes, and/or the current National Electric Code (NEC).

⚠ WARNING

Use only included 24V DC driver. Factory warranty will be void if used with a non-recommended power supply, transformer, or driver.

⚠ WARNING

To reduce the risk of fire, electric shock or injury to persons, make sure that the electrical power to the system is disconnected at the source prior to installation or any servicing.

⚠ WARNING

Never fold Trulux® tape light or bend past the minimum bending radius of 1" whether lighted or unlighted.

⚠ WARNING

- **INGESTION HAZARD:** This product contains a button cell or coin battery.
- **DEATH** or serious injury can occur if ingested.
- A swallowed button cell or coin battery can cause **Internal Chemical Burns** in as little as **2 hours**.
- **KEEP** new and used batteries **OUT OF REACH OF CHILDREN**.
- **Seek immediate medical attention** if a battery is suspected to be swallowed or inserted inside any part of the body.



SAFETY INFORMATION

- Read all installation instructions before beginning; if not qualified, do not attempt installation. Contact a qualified electrician.
- To reduce the risk of fire, electric shock, or injury to persons, pay close attention to this manual and stay within its guidelines when using this product. Save these instructions for future use.
- Do not cover this product as the covering may cause rope to overheat, melt, or ignite.
- Do not operate Trulux® tape light while on the reel, nor while it is coiled.
- This IP54 rated tape light is cULus Listed and suitable for indoor use in dry and damp locations, but not for direct contact with water or moisture.
- Do not submerge flexible light in liquids nor use the product in the vicinity of standing water or other liquids, or where water can accumulate.
- Do not route the cord or tape light through walls, ceilings, doors, windows, or any similar part of the building structure.
- Secure tape light using only the attached adhesive strip.
- Do not secure this product or its cord with staples, nails, or like means that may damage the outer jacket or cord insulation.
- Do not use if there is any damage to the tape light, LED diodes, or power cord insulation; inspect periodically.
- Do not install on gates or doors, or where subject to continuous flexing.
- Do not install in tanks or enclosures of any kinds.
- This kit includes a 24V DC plug-in power supply (3A) that is cULus Listed for dry location use. Use only the power supply provided. This power supply allows for a maximum run of 16.4 feet of tape light. Do not exceed 16.4 feet of tape light in any single run.

WARNING - KEEP BATTERIES OUT OF REACH OF CHILDREN!

- The handheld remote control included utilizes a 3V CR2025 battery.
- Batteries are not a toy! If swallowed, it could cause severe injury or death in just 2 hours due to chemical burns and potential perforation of the esophagus. Even used batteries may cause severe injury or death.
 - If you suspect your child has swallowed or inserted a button battery, immediately seek urgent medical assistance. Call a local poison control center for treatment information.
 - Remove and immediately recycle or dispose of used batteries according to local regulations and keep away from children. Do NOT dispose of batteries in household trash or incinerate.
 - Non-rechargeable batteries are not to be recharged.
 - Do not force discharge, recharge, disassemble, heat above 60°C, or incinerate. Doing so may result in injury due to venting, leakage, or explosion resulting in chemical burns.
 - Ensure the batteries are installed correctly according to polarity (+ and -).
 - Do not mix old and new batteries, different brands or types of batteries, such as alkaline, carbon-zinc, or rechargeable batteries.
 - Remove and immediately recycle or dispose of batteries from equipment not used for an extended period of time according to local regulations.
 - Always completely secure the battery compartment. If the battery compartment does not close securely, stop using the product, remove the batteries, and keep them away from children.

KIT CONTENTS:

- (1) 16.4ft (5m) Reel of Trulux® RGBW IP54 (unjacketed) tape light
- (1) Inline LED Controller/Receiver
- (1) RGB+W Radio Frequency Remote Control
- (1) 24V DC Power Supply (3A)

- (1) 15ft Reel of 20AWG wire
- (3) Tape-to-Tape snap connectors
- (6) Tape-to-Wire snap connectors

INSTALLING TRULUX® TAPE LIGHT (See Figure 1):

Make all connections and mount in place prior to providing power to system. Trulux® Tape Light includes a 3M adhesive backing: Allow adhesive to cure 24 hours prior to first use. This product is designed to be mounted to a smooth, clean, non-moving surface.

1. Determine the placement of tape light and whether there will be cuts, splices, or jumpers needed. Make any cuts, splices, or jumps prior to moving on to Step 2. See CUTTING & LINKING TRULUX® TAPE LIGHT KITS on next page for more information on cutting and/or linking Trulux® Tape Light. Consider the placement of the power supply and ensure there is no tension from start of tape light to power supply.
2. Peel the protective backing from the tape light and press the Trulux® tape light into place. For best results, once the VHB protective sheet is removed, the tape should not be repositioned, removed, or re-used.
3. Connect the mating DC plugs from the start of the tape light reel to the LED controller/receiver.
4. Connect the mating DC plugs from the LED controller/receiver to the DC power supply.
5. Plug DC power supply into standard 120V wall socket.

FIGURE 1

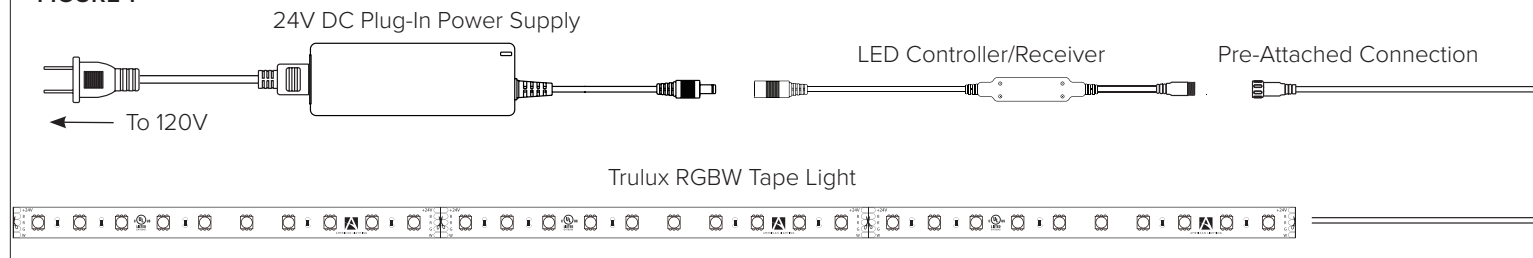

INSTALLATION INSTRUCTIONS

HTL-RGBW-5MKIT



LAYOUT CONSIDERATIONS:

Pay close attention to the following tape light maximum run lengths. Use only the 24V DC power supply provided.

Tape Light Series	Wattage	Reel Length	Cuttability	Tape Light Kit Maximum Run
HTL-RGBW Series	4.4W/ft	16.4 feet (5m)	Every 6.56"	16.4 feet (5m)

CUTTING & LINKING TRULUX® TAPE LIGHT KITS (See Figures 2-7):

Do not exceed the maximum tape light run length of 16.4 feet in any single run. Use only the 24V DC power supply provided. Cut increments are clearly marked on the tape light (every 3.94"). Ensure an even cut along the center of the copper conductors to ensure enough surface area is exposed for snap connector pins to pierce through.

Making a Tape-to-Tape Connection (See Figures 3-5):

1. Ensure the polarity of the conductors on the two pieces of tape light to be connected are aligned. See Figure 3.
2. Using a tape-to-tape snap connector, open both sides of the connector so the metal teeth inside are exposed. See Figure 4.
3. Peel a small portion of the protective backing from the tape light on the end to be connected, then insert cut tape light end so the copper pad conductors are aligned with the metal teeth inside.
4. Close snap connector and use pliers to ensure the connector "snaps" through the tape light. See Figure 5.

To make a Tape-to-Wire Connection (See Figures 6-9):

1. Using a tape-to-wire snap connector, follow steps 1-4 from "Making a Tape-to-Tape Connection" above to connect tape light.
2. Ensure polarity of the conductors on the connected piece of tape light and the polarity of the wires align. See Figure 6.
3. Cut desired length of wire from the 15ft reel of wire included being sure to leave approximately 1/2' on each end to be connected.
3. Separate wires slightly so they fit in the grooves of the snap connector. There is no need to strip the wire. See Figure 7.
4. Insert the cut wire into the slots of the snap connector so the wire is aligned with the metal teeth inside. See Figure 8.
5. Close snap connector and use pliers to ensure the connector "snaps" through the wire. See Figure 9.

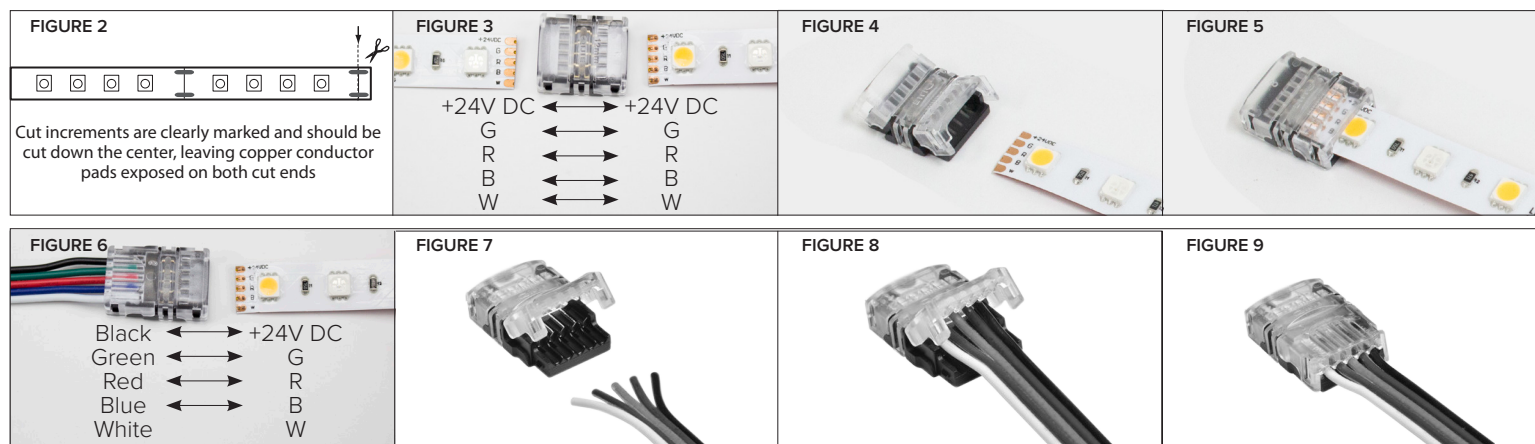

USING THE RF REMOTE CONTROLLER (See Figure 8):

Remove protective film from battery compartment prior to use. This remote includes a 3V CR2025; only replace with the same type battery. Please dispose of old batteries properly.

- 1:** Turn On/Off
2/3: Dynamic lighting mode with 18 presets
4/5: 10 speed levels in Dynamic Mode
6: Demo mode: Filters through 9 presets
7/8: Filter through pre-set colors
9/10: 10 dimming levels +/-
11/12/13/14/15/16/17: Color preset hotkeys

FIGURE 8

