



## INSTALLATION INSTRUCTIONS

MLINK-120-30-XX

**⚠ WARNING**

These products may represent a possible shock or fire hazard if improperly installed or attached in any way. Products should be installed in accordance with these instructions, current electrical codes, and/or the current National Electric Code (NEC).

**⚠ WARNING**

To reduce the risk of fire, electric shock or injury to persons, make sure that the electrical power to the system is disconnected at the source prior to installation or any servicing.

**⚠ WARNING**

Caution: Injury to persons and damage to the fixture and/or mounting surface may result if the fixture is pulled from the surface. To reduce the likelihood of such injury or damage, mount on a surface that is mechanically sound.

**⚠ WARNING**

The National Electrical Code (NEC) does not permit cords to be concealed where damage to insulation may go unnoticed. To prevent fire danger, do not run cord behind walls, ceilings, soffits, or cabinets where it may be inaccessible for examination. Cords should be visually examined periodically and immediately replaced when any damage is noted.

**SAFETY INFORMATION**

- Read all instructions before beginning; Save these instructions for future use.
- To reduce the risk of fire, electric shock, or injury to persons, pay close attention to this manual and stay within its guidelines when using this product.
- This fixture is intended for indoor use in dry or damp locations only. Do not use in the vicinity of standing water or liquids. Do not submerge in water or liquids.
- **WARNING:** Not intended for wet locations. Suitable for indoor, dry locations only.
- Do not use if there is any damage to the unit or power cord's insulation. Inspect periodically.
- Do not route cords or units through walls, doors, windows or any similar part of a building structure.
- Secure units using mounting clips (sold separately). Do not secure unit or its power cord with staples, nails, or any other sharp objects that may damage fixture.
- To maintain product integrity: do not bend, step on, or subject to pressure or flexing. Do not mount on uneven surfaces.
- **Risk of shock or fire hazard:** This fixture has a maximum run length of 65.6 ft (20 meters). Do not exceed maximum run length in any connection series.
- **CAUTION:** To reduce the risk of electric shock or injuries to persons, use only insulated staples or plastic ties to secure cords and only route/secure cords to that they will not be pinched or damaged when the cabinet is pushed to the wall.
- **CAUTION:** To reduce the risk of electric shock or injuries to persons, do not operate fixture with missing or damaged lens or wiring compartment cover.
- **WARNING! CAUTION - RISK OF FIRE:** Keep fixtures away from curtains and other combustible materials.
- Do not operate without an end connector cover/cap in place for any Molex ports/connectors not in use.
- The National Electrical Code (NEC) does not permit cords to be concealed where damage to insulation may go unnoticed.
- This product is suitable for use in dimming circuits. It is compatible with most standard TRIAC, CL, and ELV dimmers (5-100% light control).

**PRODUCT INFORMATION:**

Each length of Microlink 120V AC (6", 12", 24", or 36") includes (1) 18" power connection cable with open end, (1) end cap, and mounting clip(s) with screws.

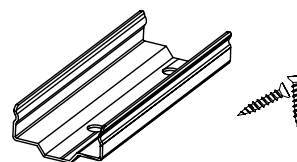
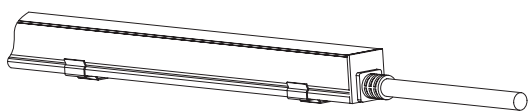

Additional accessories are sold separately as follows:

Connector w/ AC Plug	
Connector w/ Bare Wire	
6" Linking Jumper	

12" Linking Jumper	
"L" Connector LEFT	
"L" Connector RIGHT	

Splice	
4" Mounting Clip	
Slimline Hardwire Box	

**PRIOR TO INSTALLATION:**

Determine the location of installation and lengths of Microlink 120V AC that will be needed. Determine what power and connection accessories you will be utilizing. Do not exceed the max run length of 65.6 ft (or 20 meters) single series run. Remove the clear plastic wrap from each fixture prior to installation. Not intended for wet locations. Suitable for indoor, dry locations only.



## INSTALLATION INSTRUCTIONS

MLINK-120-30-XX

**LINKING MICROLINK (Figure 1):**

1. To link fixtures, use either a jumper cable or splice connector.
2. Plug jumper or splicer directly into the first Microlink segment until connection is secure.
3. Plug the other end of the jumper or splicer directly into the next Microlink segment.

**POWERING MICROLINK (Figures 2&3):**

This LED product is designed to be used with a 120V AC power source. Be sure the electrical system in the space has been properly checked and tested. Ensure all parts and pieces have been correctly linked and mounted. The first fixture in a run should have a power connection with 120V AC power source and the last fixture in a run should have an end cap attached.

1. Make sure all Microlink segments are connected to each other and securely installed in place.

There are three options for powering the Microlink 120V AC:

- A) 120V AC wall receptacle: Use konkit with 120V AC plug to connect with 120V AC wall receptacle.
  - B) Hardwire Junction Box Accessory: Connect supply wires to junction box accessory ensuring to match polarity (neutral - white, hot - black, ground - green). Using a power jumper, connect the first fixture in the series to the junction box accessory.
  - C) Bare Wire Straight to Standard Junction Box: Use konkit with bare wire to connect directly to standard junction box ensuring to match polarity (neutral - white, hot - black).
2. If using a dimming AC circuit, make sure to use a standard TRIAC, CL, or ELV dimmer.
  3. Ensure the power cord is accessible for maintenance and periodic inspections.

Note: In order to prevent short circuits caused by incorrect connections, the main body and connecting accessories are designed with male and female structures.

**MOUNTING MICROLINK (Figure 4):**

1. Microlink 120V AC can be surface or recessed mounted. See Figure 4 for recessed cut-out details.
2. Position clips and mark the location of each mounting clip in a straight line so that the fixture can snap into each clip.
3. Using provided screws, install mounting clips on the line, taking into account the lengths of each fixture being used.
4. Clip/snap the groove sides of the Microlink 120V AC into clips.

Note: Begin with first fixture of run attached to surface and add additional fixtures to the run one at a time.

FIGURE 1

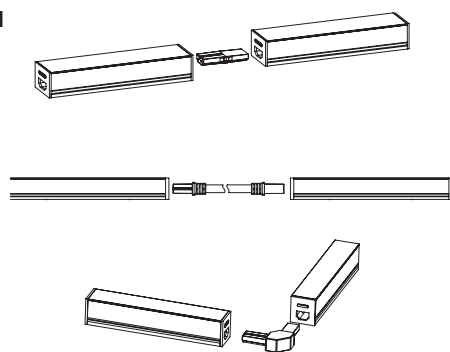

FIGURE 2

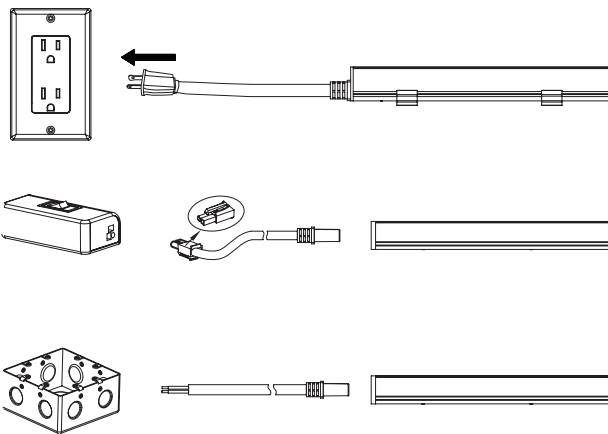

FIGURE 3

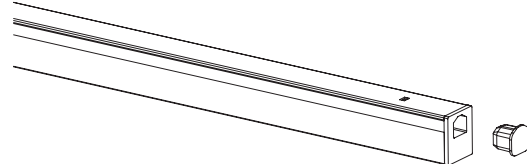
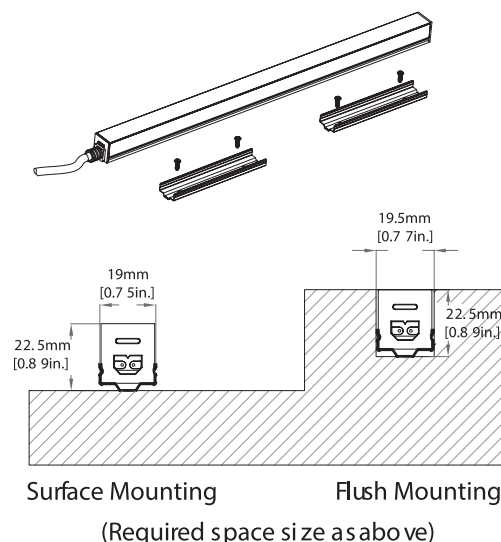

FIGURE 4

**CARE AND MAINTENANCE:**

For cleaning, use a soft, dry or damp cloth. Do not use harsh chemicals or abrasives.