

## INSTALLATION INSTRUCTIONS

### RF-NFL-RGBW-12VAC-6MKIT Series



#### ⚠ WARNING

These products may represent a possible shock or fire hazard if improperly installed or attached in any way. Products should be installed in accordance with these instructions, current electrical codes, and/or the current National Electric Code (NEC).

#### ⚠ WARNING

Use this fixture with included connection kit and 12V AC transformer only. Any other power feed may damage the fixture.

#### ⚠ WARNING

To reduce the risk of fire, electric shock or injury to persons, use this flexible light only with American Lighting recommended drivers, controllers, power connectors, splices and extensions.

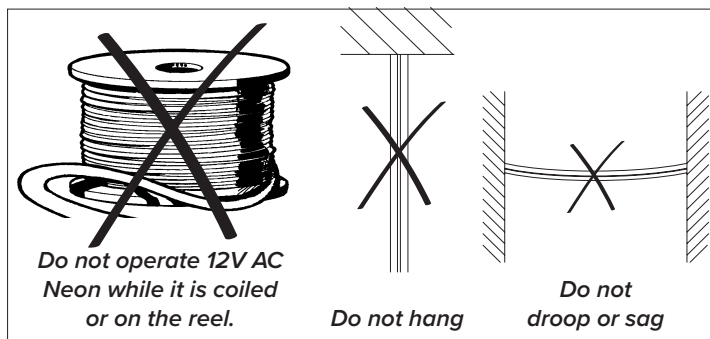

#### ⚠ WARNING

To reduce the risk of fire, electric shock or injury to persons, make sure that the electrical power to the fixture is disconnected at the source prior to installation or any servicing.

## SAFETY INFORMATION

- Read all installation instructions before beginning; if not qualified, do not attempt installation. Contact a qualified electrician.
- To reduce the risk of fire, electric shock, or injury to persons, pay close attention to this manual and stay within its guidelines when using this product. Save these instructions for future use.
- Do not cover this product as the covering may cause product to overheat, melt, or ignite.
- Risk of fire or electric shock. Uncoil flexible light prior to plugging in. Do not operate 12V AC Neon while it is tightly coiled.
- Do not route the cord or 12V AC Neon through walls, ceilings, doors, windows, or any similar part of the building structure.
- Secure this flexible light using only the included factory recommended mounting clips or channel (NFL-RGBW-FCHAN-1M), sold separately.
- Do not secure this product or its cord with staples, nails, or like means that may damage the outer jacket or cord insulation.
- Do not use if there is any damage to the PU housing or power cord insulation. Inspect periodically.
- Do not install on gates or doors, where subject to continuous flexing.
- Do not install near flammable liquids or other flammable materials.
- Follow instructions carefully when cutting 12V AC Neon. Ensure all end caps are properly sealed with appropriate silicone or PU type glue.
- 12V AC Neon can only be cut at specific intervals as indicated by the cutting marks printed on the side of the PU housing (35.6mm or 1.4"). Failure to cut at a cut mark will result in a loss of light. Before making any cuts or attaching any power cords, be sure power source is disconnected at the source!
- This product is designed for use by a qualified installer.
- This product is for decorative use only. Not to be used by children as a toy. Keep out of reach of small children.
- The rated ambient temperature range for 12V AC Neon is -4°C (-40°F) to 60°C (140°F).
- The maximum bend radius of 12V AC Neon is 30cm or 11.8". Do not twist, drop, hang, sag, or bend product in any way other than intended. This product can only bend laterally in relation to its light output. See Figure 1 below for reference.
- **WARNING - KEEP BATTERIES OUT OF REACH OF CHILDREN!** Batteries are not a toy!
  - The handheld remote control included utilizes a 3V CR2025 battery; If swallowed, it could cause severe injury or death in just 2 hours due to chemical burns and potential perforation of the esophagus. If you suspect your child has swallowed or inserted a button battery, immediately seek urgent medical assistance.
  - Do not dispose of batteries in fire as they may explode or leak. Please dispose of used batteries immediately and safely. Only replace with the same battery type.
  - Examine devices and make sure the battery compartment is correctly secured, e.g. that the screw or other mechanical fastener is tightened. Do not use if compartment is not secure.

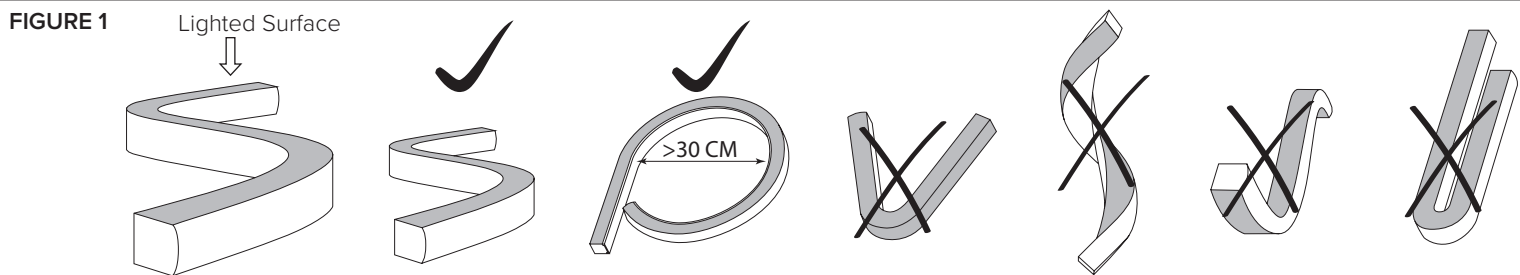

## WARNING

**When using outdoor portable lighting products, basic safety precautions should always be followed to reduce the risk of fire, electric shock, and personal injury, including the following:**

- Use dielectric grease and shrink tube at all power connections, including end cap when using outdoors.
- Use ground fault circuit interrupter (GFCI) protection on the circuit(s) or outlet(s) when using outdoors.
- Use only UL approved outdoor extension cords, such as type SW, SOW, STW, STOW, SJW, SJOW, SJTW, or SJTOW. This designation is marked on the jacket of the extension cord.

## INSTALLATION INSTRUCTIONS

### RF-NFL-RGBW-12VAC-6MKIT Series



#### INSTALLING 12V AC NEON:

Disconnect power at the source prior to attempting installation or service of product. Use this fixture with included power cable and 12V AC rectifier only. Any other power feed may damage the fixture.

1. Determine the desired locations and lengths of 12V AC Neon, as well as the location for the RF receiver and 12V AC rectifier, to be installed. Use this information to determine locations and sizes of 12V DC power supplies (sold separately).
2. Install mounting clips or aluminum channel (NFL-RGBW-FCHAN-1M) by screwing the clip or channel into a solid, sturdy surface. See Figure 2. Mounting clips should be evenly spaced and be a maximum of 3 feet apart. The distance between two parallel lines of 12V AC Neon must be at least 1/2".
3. Gently push the 12V AC Neon into the mounting clips or channel starting at the beginning of the run and moving down the line towards the end. Leave enough room for the power cable to reach the power supply. End caps cannot be installed within the aluminum channel. See Figure 3. Ensure the NeoFlux does not sag and does not bend more than the maximum bend radius of 30cm at any point.
4. Connect the RF Receiver to the beginning of the 12V AC Neon run using the preinstalled power cable. See Figure 4.
5. Connect the 12V DC power supply to line voltage and then connect to 12V AC rectifier using bare wire lead.
6. Reconnect power at source.

#### CUTTING 12V AC NEON:

Disconnect power at the source prior to attempting installation or service of product.

1. Determine the desired location of the cut based on the cutting increments marked on the bottom of the 12V AC Neon (35.6mm or 1.4").
2. Using an appropriate utility blade, gently cut straight down through the body of the 12V AC Neon directly on the cutting increment mark on the bottom. Do not use scissors or bolt cutters. Do not cut diagonally or horizontally as this may damage the product. See Figure 5.
3. Seal cut-end using included end cap and an appropriately rated silicone or PU glue (not included). See Figure 6.

#### USING THE RF REMOTE CONTROLLER (See Figure 7):

Remove protective film from battery compartment prior to use. This remote includes a 3V CR2025; only replace with the same type battery. Please dispose of old batteries properly.

**1:** Turn On/Off

**2/3:** Dynamic lighting mode with 21 presets

**4/5:** 10 speed levels in Dynamic Mode

**6:** Demo mode

**7/8:** Filter through pre-set colors

**9/10:** 10 dimming levels +/-

**11/12/13/14/15/16/17:** Color preset hotkeys

#### TROUBLESHOOTING:

Light is not functioning

- Check that power is on
- Check whether the connection to the outlet is secure
- Change the battery in the remote
- Clean the front of the controller
- Make sure pull-tab is remove from remote
- Ensure remote is pointed at the receiver

#### CARE AND MAINTENANCE:

1. For cleaning, use a soft, dry or damp cloth. Do not use harsh chemicals or abrasives.

FIGURE 2

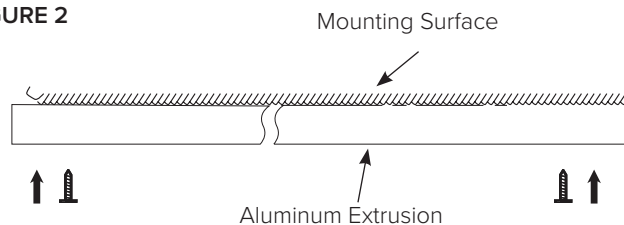

FIGURE 3

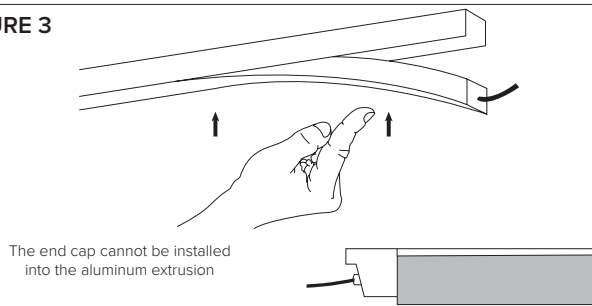

FIGURE 4

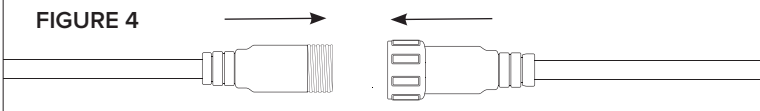

FIGURE 5

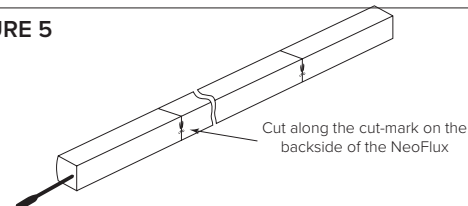

FIGURE 6

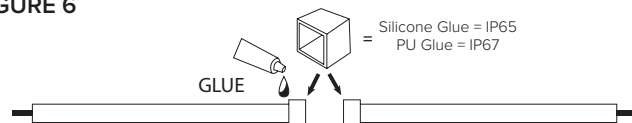

FIGURE 7

