

## INSTALLATION INSTRUCTIONS

### RP-DL3-RHYM

#### SAFETY INFORMATION

- Read all instructions before beginning; save these instructions for future use.

#### KIT INCLUDES:

- Hangar bars, brackets, and screws
- Galvanized steel round opening rough-in plate for mounting downlight fixtures

This plate is compatible with both 3inch round and 3inch square downlight fixtures. The initial opening is circular. For square downlight installations, simply remove the excess portion using a tool.

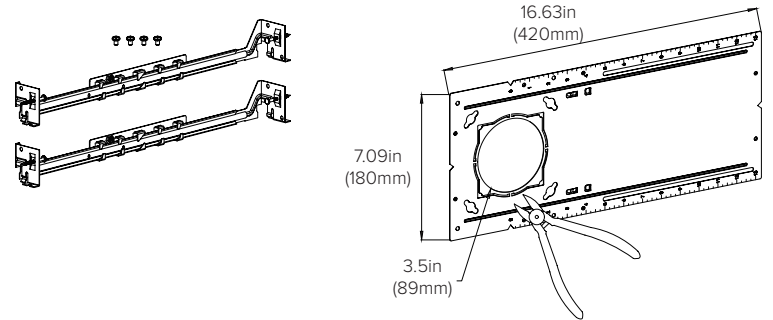

#### NEW CONSTRUCTION PLATE DRYWALL INSTALLATION - A (See Figures 1-4):

**New Construction plate for stud/joist mounting, without adjustable hangar bars.**

1. Secure plate to the bottom of studs/joist using screws. See Figure 1.
2. Make appropriate wiring connections as required, following downlight instructions to complete installation. See Figures 2, 3, and 4.

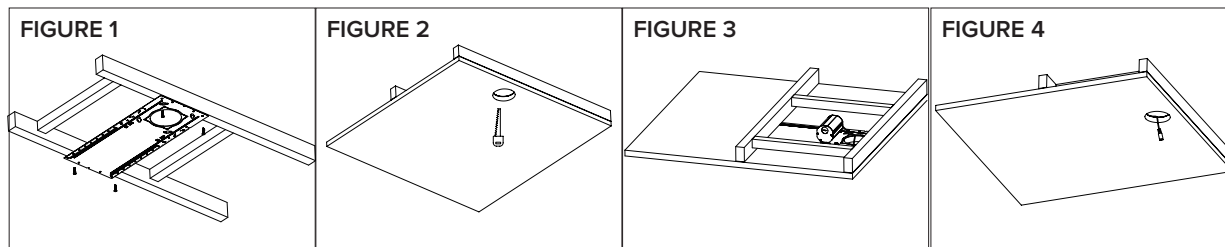

#### NEW CONSTRUCTION PLATE DRYWAL INSTALLATION - B (See Figure 5-9):

**New Construction plate for stud/joist mounting, with adjustable hangar bars.**

1. Attach adjustable hangar bars to the rough-in plate using included screws. See Figure 5.
2. Secure hangar bars to the side of studs/joist using nails. See Figure 6.
3. Make appropriate wiring connections as required, following downlight instructions to complete installation. See Figures 7, 8, and 9.

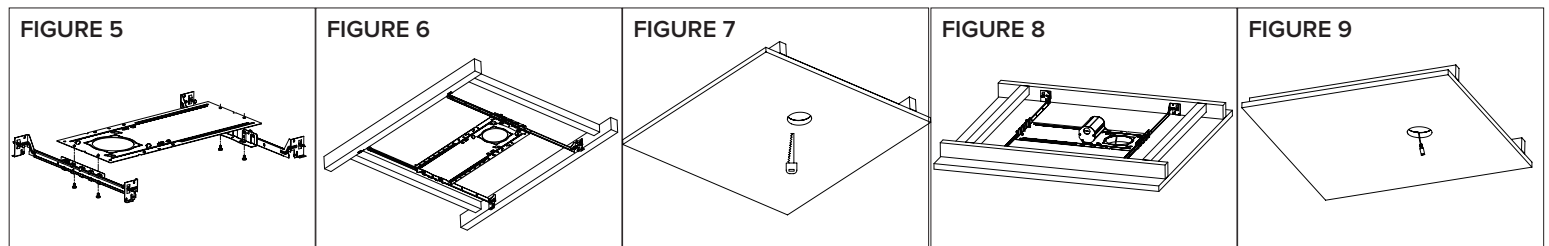

#### NEW CONSTRUCTION PLATE T-GRID INSTALLATION (See Figure 10-14):

**New Construction plate for T-grid ceilings, fits standard 2' x 2' and 2' x 4' T-grids with adjustable hangar bars.**

1. Attach adjustable hangar bars to the rough-in plate using included screws. See Figure 10.
2. Secure hangar bars to the T-grid using the slots in the end of the hangar bars. See Figure 11.
3. Make appropriate wiring connections as required, following downlight instructions to complete installation. See Figures 12, 13, and 14.

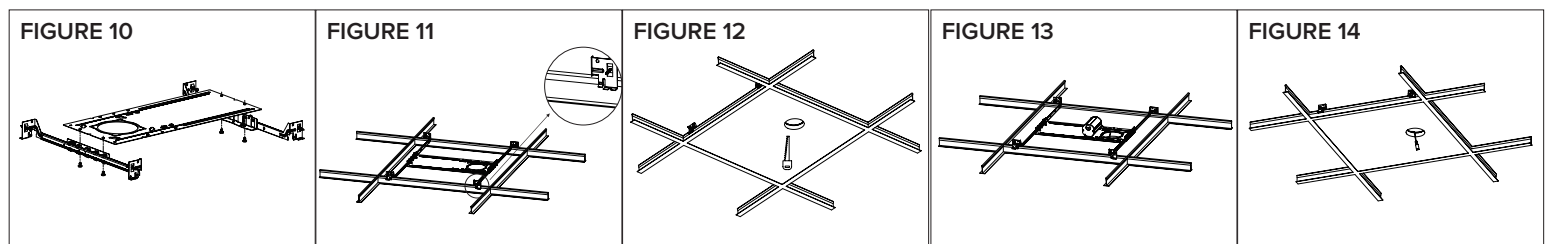

## INSTALLATION INSTRUCTIONS

## RP-DL3-RHYM

**AFFIX DRIVER TO ROUGH-IN PLATE**

1. For securing driver housing to the rough-in plate, bend the tabs upwards, place the driver mounting holes over the tabs, and slide to lock into place. See Figure 15.

For new construction applications: Hardwire box shall be firmly secured to studs, joists, or similar fixed structural units.

For remodel applications: Hardwire box is not required to be secured after the plates, studs, joists, or structural units have been concealed.

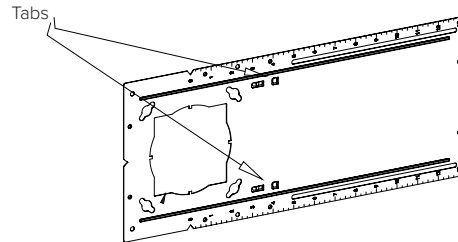
**FIGURE 15****5-YEAR LIMITED PRODUCT WARRANTY**

This product is warranted to be free from defects in material and workmanship for a period of five (5) years from the date of purchase. Products that prove to be defective during this period will be either repaired (i.e. replacement of defective electronics, defective parts of the fixture housing, lens, wiring, switching or lamp sockets; excluding the lamp) or replaced, at the discretion of American Lighting, Inc. claims for defective products must be submitted to the retail location from which the product was purchased within the warranty period. Upon submission of proper return claim documentation and product to American Lighting, Inc. by the retailer, American Lighting, Inc. reserves the right to inspect the product for misuse or abuse. Claims for indirect or consequential damages or for product that, in American Lighting, Inc.'s opinion has been misused, will be denied. This is a warranty of product reliability only and not a warranty of merchantability or fitness for a particular purpose. American Lighting, Inc. shall have no liability whatsoever in any event for payment of incidental or consequential damages, including, without limitations, installation costs and damages for personal injury and property. These products may represent a possible shock or fire hazard if improperly installed or altered in any way. This warranty applied only to product that has been properly installed in accordance with instruction sheet and current local codes and/or the National Electrical Code. Warranty does not apply to any product that has been improperly installed or in situation where components have been altered in any way. This warranty: (1) excludes expendable parts including but not limited to light bulbs, batteries; (2) carries a 2-year finish warranty protecting finish against tarnishing, flaking, and discolorations; (3) shall be void if this lighting fixture is not installed in the U.S.A.; and (4) does not cover any losses, labor, injuries to persons/property or costs. This warranty does give you specific legal rights and you may have other rights, which vary from state to state. Be careful, it is recommended that installation be done by a qualified professional; the purchaser has sole responsibility for proper installation in compliance with all state and local code requirements. Seller's employees are not qualified to advise you on the use of this Merchandise. Any oral representation(s) made will not be binding on seller or its employees. The rights under this limited warranty are to the original purchaser of the Merchandise and may not be transferred to any subsequent owner. This limited warranty is in lieu of all warranties, expressed or implied including warranties or merchantability and fitness for a particular purpose. Seller shall not be liable for any special, incidental, or consequential damages. The sole exclusive remedy against the seller will be for the replacement of any defects as provided herein, as long as the seller is willing or able to replace this product or is willing to refund the purchase price as provided above.

**For questions/comments, technical assistance, or repair parts - Please call toll free at 1-800-285-8051 (M-F 8am-5pm), CST)**