

INSTALLATION INSTRUCTIONS

SPKPL-VLTD & SPKPL-VLTS



WARNING

These products may represent a possible shock or fire hazard if improperly installed or attached in any way. Products should be installed in accordance with these instructions, current electrical codes, and/or the current National Electric Code (NEC).

WARNING

This fixture requires a 120V power source. Ensure the voltage of the power source is compatible. Disconnect supply power at the source prior to attempting installation. Proper grounding is required for safety.

SAFETY INFORMATION

- Read all instructions before beginning; save these instructions for future use.
- To reduce the risk of fire, electric shock, or injury to persons, pay close attention to this manual and stay within its guidelines when using this product.
- If you are unsure about your wiring, consult a qualified electrician or local electrical inspector, and check your local electrical code.
- There are no serviceable parts inside this fixture. Do not attempt to dismantle or service this fixture in any way.
- Use only on 120VAC 60Hz circuits.
- LEDs are not serviceable. Do not attempt to open the LED light engine.
- LEDs are bright. Do not look directly into fixture.
- Not intended for recess mounting in any type of installation.
- Use minimum 18 AWG coated wire for supply leads.
- If protective lens cover is broken, the fixture must be replaced. Do not use without a protective cover.

INSTALLATION (SEE FIGURE 1): This fixture requires a 120V AC power source. Disconnect power at the source fuse or circuit breaker box before attempting installation. Ground the fixture to avoid potential electric shock and ensure reliable start. Double-check all connections to be sure they are tight and correct. This fixture utilizes Bluetooth Wireless Technology and can be controlled via the Spektrum+ Smart Lighting App. It is not intended to be used with a standard dimmer switch.

1. Turn off power at the source.
2. Screw the mounting plate onto the junction box (standard 4" octagonal or round). Ensure the grounding screw is facing outward and the two fixture mounting screw holes align vertically with the desired orientation of the fixture's canopy.
3. Pull the wires through the center of the installed mounting plate, then affix the grounding wires (yellow/green) to the grounding screw on the mounting plate. Now, make supply wire connections to fixture (white to white, black to black).
4. Push the fixture on to the mounting plate, aligning the two fixture mounting screw holes with the two screw holes on the fixture's canopy.
5. Use the canopy screws to securely fasten the canopy to the mounting plate.
6. To ensure a weatherproof seal, use weatherproof silicone sealant around the edge of the canopy against the mounting surface.
7. Turn on power to test fixture operation. **Follow the Spektrum+ Smart Lighting App guide for operation and functionality.**

FIGURE 1

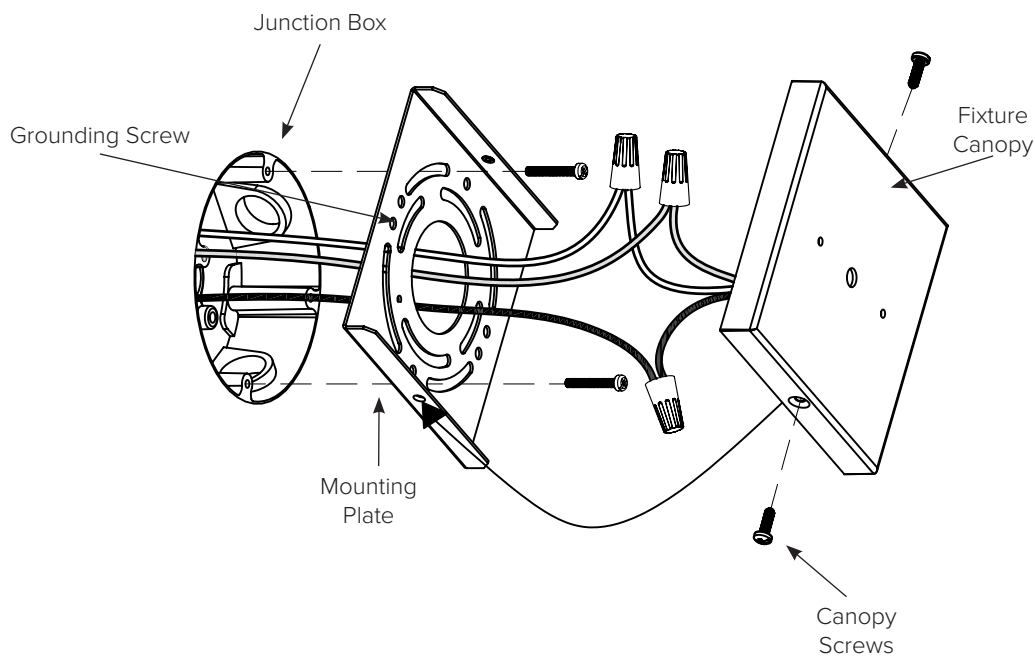

INSTALLATION INSTRUCTIONS**SPKPL-VLTD & SPKPL-VLTS**

CONTROLLING THE FIXTURE: The attached LED controller/receiver utilizes Bluetooth Wireless Technology and can be controlled via the Spektrum+ Smart Lighting App and/or the Spektrum+ Smart Switch (SPKPL-CTRL-W-RGBTW - sold separately). It is not intended to be used with a standard dimmer switch.

DISTANCE OF CONTROL CAPABILITY: 25 meters (approx. 80ft)

RESET THE DEVICE: Power the device ON and OFF 3 times in succession. The device will pulse BLUE once reset.

USING THE SPEKTRUM+ SMART LIGHTING APP: Please follow the Spektrum+ Smart Lighting App guide.

CARE AND MAINTENANCE:

1. Use only a mild soap and water with soft cloth to clean the fixture. Harsh chemicals will damage the finish.
2. Do not wipe the fixture with a rough cloth that may scratch the finish or the lens.

FCC Compliance Statement

This device complies with Part 15 of the FCC Rules. Operation is subject to the following two conditions:

1. This device may not cause harmful interference, and
2. This device must accept any interference received, including interference that may cause undesired operation.

FCC WARNING

This equipment has been tested and found to comply with the limits for a Class B digital device, pursuant to Part 15 of the FCC Rules. These limits are designed to provide reasonable protection against harmful interference in a residential installation. This equipment generates, uses and can radiate radio frequency energy and, if not installed and used in accordance with the instructions, may cause harmful interference to radio communications. However, there is no guarantee that interference will not occur in a particular installation. If this equipment does cause harmful interference to radio or television reception, which can be determined by turning the equipment off and on, the user is encouraged to try to correct the interference by one or more of the following measures:

- Reorient or relocate the receiving antenna.
- Increase the separation between the equipment and the receiver.
- Connect the equipment into an outlet different from that to which the receiver is connected.
- Consult the dealer or an experienced radio/TV technician for help.

Changes or modifications not expressly approved by the party responsible for compliance could void the user's authority to operate the equipment.

5-YEAR LIMITED PRODUCT WARRANTY

This product is warranted to be free from defects in material and workmanship for a period of five (5) years from the date of purchase. Products that prove to be defective during this period will be either repaired (i.e. replacement of defective electronics, defective parts of the fixture housing, lens, wiring, switching or lamp sockets; excluding the lamp) or replaced, at the discretion of American Lighting, Inc. claims for defective products must be submitted to the retail location from which the product was purchased within the warranty period. Upon submission of proper return claim documentation and product to American Lighting, Inc. by the retailer, American Lighting, Inc. reserves the right to inspect the product for misuse or abuse. Claims for indirect or consequential damages or for product that, in American Lighting, Inc's opinion has been misused, will be denied. This is a warranty of product reliability only and not a warranty of merchantability or fitness for a particular purpose. American Lighting, Inc. shall have no liability whatsoever in any event for payment of incidental or consequential damages, including, without limitations, installation costs and damages for personal injury and property. These products may represent a possible shock or fire hazard if improperly installed or altered in any way. This warranty applied only to product that has been properly installed in accordance with instruction sheet and current local codes and/or the National Electrical Code. Warranty does not apply to any product that has been improperly installed or in situation where components have been altered in any way. This warranty: (1) excludes expendable parts including but not limited to light bulbs, batteries; (2) carries a 2-year finish warranty protecting finish against tarnishing, flaking, and discolorations; and (3) does not cover any losses, labor, injuries to persons/property or costs. This warranty does give you specific legal rights and you may have other rights, which vary from state to state. Be careful, it is recommended that installation be done by a qualified professional; the purchaser has sole responsibility for proper installation in compliance with all state and local code requirements. Seller's employees are not qualified to advise you on the use of this Merchandise. Any oral representation(s) made will not be binding on seller or its employees. The rights under this limited warranty are to the original purchaser of the Merchandise and may not be transferred to any subsequent owner. This limited warranty is in lieu of all warranties, expressed or implied including warranties of merchantability and fitness for a particular purpose. Seller shall not be liable for any special, incidental, or consequential damages. The sole exclusive remedy against the seller will be for the replacement of any defects as provided herein, as long as the seller is willing or able to replace this product or is willing to refund the purchase price as provided above.

For questions/comments, technical assistance, or repair parts - Please call toll free at 1-800-285-8051 (M-F 8am-5pm), CST)