

# Ceiling LED Pendant

**CH9522**  
INSTALLATION SHEET

## START FROM HERE

- Make sure power is completely off at the fuse box.
- Have your fixture installed by a qualified licensed electrician
- Prepare everything in a clear area.
- Wear gloves at all times during this installation.
- Read instructions carefully before you start assembly.
- Keep this instruction sheet for future reference.

**Technical Support:** 1-877-452-6858

### Please Note:

- All Kuzco LED fixtures come with pre-wired LED module(s).
- Unless instructed to do so, please do not touch any part of the LED module(s) as any unnecessary contact with the module could cause permanent damage.
- For dimming, an ELV (Electronic Low Voltage) type of dimmer is required.

**CAUTION:** This fixture weighs in excess of 30 Lbs! Utilize appropriate anchors and junction box hardware to support the load. The installer should be aware of the weight and fully confirm that the junction box has been installed in a manner appropriate to supporting the load. Add additional suitably rated mounting provisions to the junction box if necessary! Additionally, we strongly recommend that the installer connects the provided fixture safety cable to the junction box - and preferably to an additional secondary roof member, or other suitable point that is separately capable of supporting the full load of the fixture. This in case of failure of the primary mounting means.

1. Remove the fixture from its original packaging. Remove the mounting plate (1d) from within the inner canopy (2a) by removing decorative nut (2d) and two nuts (2b). Remove the aircraft cable from the mounting plate (1d) by loosening the cable lock (1c). Using the allen key and make sure to attach the cable to the junction box (1a) through one of the holes in the box. Tighten the lock (1c) back into place. Secure the mounting plate (1d) to the reinforced junction box (1a) with the screws (1f) provided in the hardware package.
2. Before you mount the canopy to the mounting plate select the desired length you wish the pendant to hang. To shorten or lengthen the fixture (3a) just remove or add conduit sections (2e) by threading clockwise for adding and counter clockwise for removing. Next fish the wires (2f) through the conduit sections.
3. You are now ready to mount the canopy to the mounting plate. First connect all wires correctly L live wire (black to black) N neutral wire (white to white) and G ground to ground with provided marettes (1b) from the hardware package. Align screws (1e) with the inner canopy (2a) and secure with nuts (2b). Next, secure the second canopy (2c) with large nut (2d).
4. Last steps, connect (thread clockwise) all conduit sections. Now connect (thread set screws with Allen Key) all acrylic diffusers to sockets see **illustration 1**.
5. You have now completed the installation of your fixture, enjoy.

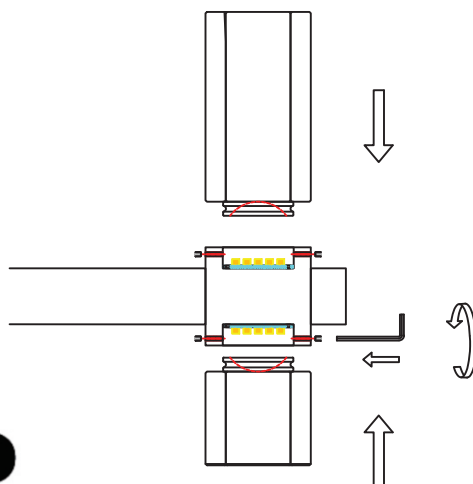
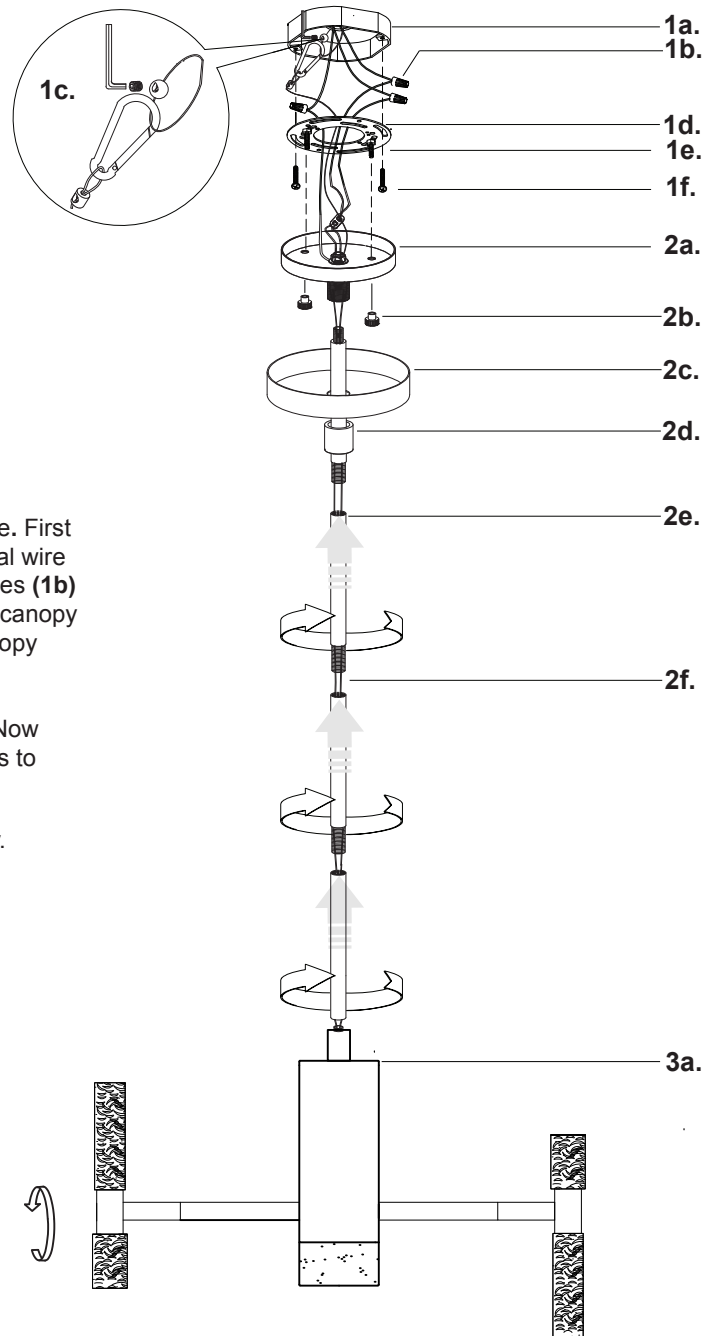

**illustration 1.**

**KUZCO**  
LIGHTING

19054 28th Avenue Surrey, BC Canada V3S 6M3  
T: 604 538 7162 TF: 1-855 85 KUZCO F: 604 538 7196  
W: kuzcolighting.com  
20170308