

## MaxLite® Edge Lit Emergency Exit Sign



### General Safety Information

- To reduce the risk of death, personal injury or property damage from fire, electric shock, falling parts, cuts/abrasions, and other hazards read all warnings and instructions included with and on the fixture box and all fixture labels.
- Before installing, servicing, or performing routine maintenance upon this equipment, follow these general precautions.
- Commercial installation, service and maintenance of luminaires should be performed by a qualified licensed electrician.
- For Residential installation: If you are unsure about the installation or maintenance of the luminaires, consult a qualified licensed electrician and check your local electrical code.
- **DO NOT INSTALL DAMAGED PRODUCT!**
- This fixture is intended to be connected to a properly installed and grounded UL listed junction box.

#### **WARNING:**

##### **RISK OF ELECTRICAL SHOCK**

- Turn off electrical power at fuse or circuit breaker box before wiring fixture to the power supply.
- Turn off the power when you perform any maintenance.
- Verify that supply voltage is correct by comparing it with the luminaire label information.
- Make all electrical and grounded connections in accordance with the National Electrical Code and any applicable local code requirements.
- All wiring connections should be capped with UL approved wire connectors.

#### **CAUTION:**

##### **RISK OF INJURY**

- Wear gloves and safety glasses at all times when removing luminaire from carton, installing, servicing or performing maintenance.
- Avoid direct eye exposure to the light source while it is on.
- Account for small parts and destroy packing material, as these may be hazardous to children.
- Do not use outdoors.
- Do not mount near gas or electric heaters.
- Use caution when handling batteries. Avoid possible shorting.
- Equipment should be mounted in locations at heights (MAX: 8ft) where it will not be subject to tampering by unauthorized personnel.
- The use of accessories not recommended by the manufacturer may cause unsafe conditions.
- Do not use this equipment for anything other than its intended use.
- Consult local building code for approved wiring and installation.
- Servicing this equipment should be performed by qualified personnel.

#### **CAUTION:**

##### **RISK OF FIRE**

- Keep combustible and other materials that can burn away from luminaire and lamp/lens
- **MIN 75°C SUPPLY CONDUCTORS.**

Models:

**EXE Series**

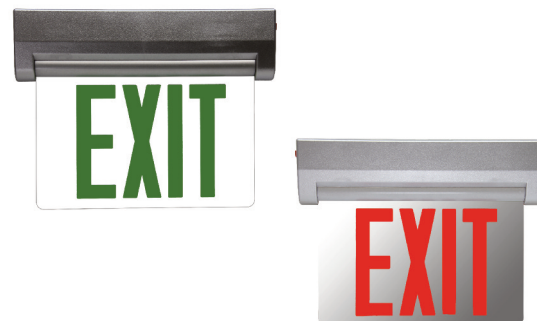

Picture is for illustration purposes only. Your model may vary.

## MaxLite® Edge Lit Emergency Exit Sign

### General Wiring Diagram

- If using 120VAC, connect the black (line) and white (common) wires to the building utility.
- If using 277VAC, connect the red (line) and white (common) wires to the building utility.
- Cap unused wires, use standard wire nuts in connection to wires.

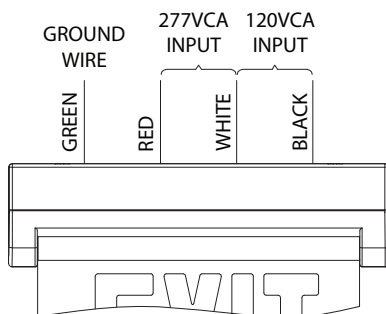

### Installation Instructions

**Note:** Refer to Fig. 1 for an exploded assembly of the unit.

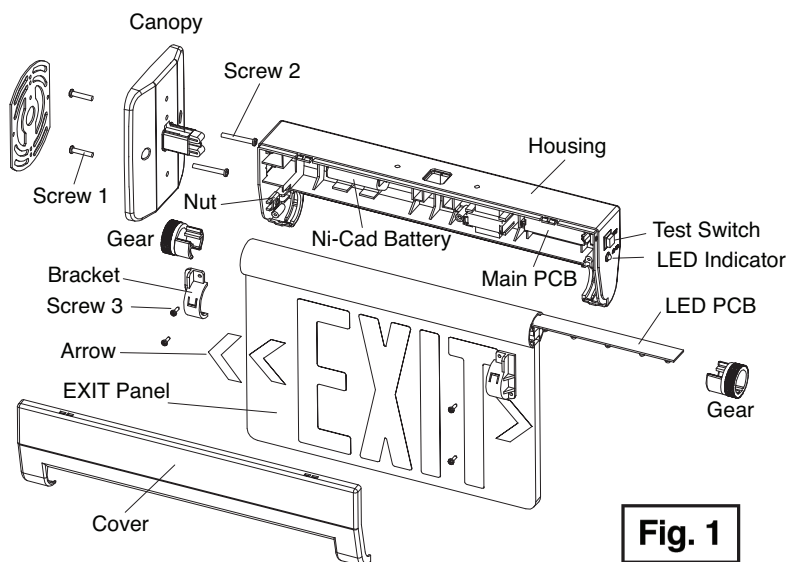

**Fig. 1**

# MaxLite® Edge Lit Emergency Exit Sign



## Installation Instructions

1. Remove the plastic square plug on top of the unit housing for ceiling and wall mounting applications. Remove the plastic square plug on the side of the unit housing for surface end mounting applications.
2. Remove the cover from the unit housing and connect the battery connectors before wiring the AC input power to the unit.
3. Feed the AC supply wires through the canopy center hole.
4. Assemble the canopy, line up the screw holes with the main housing, and secure screw 1 to secure the canopy to the housing. Refer to **Fig. 2** for wall mounting applications, **Fig. 3** for ceiling mounting applications, and **Fig. 4** for surface end mounting applications.
5. Wire the unit according to the wiring diagram. Secure all electrical connections with wire nuts.
6. Secure the metal mounting plate to the J-box.
7. Secure the unit to the metal mounting plate using locking screw 2.
8. The EXIT panel can be rotated 0-90° in either direction.

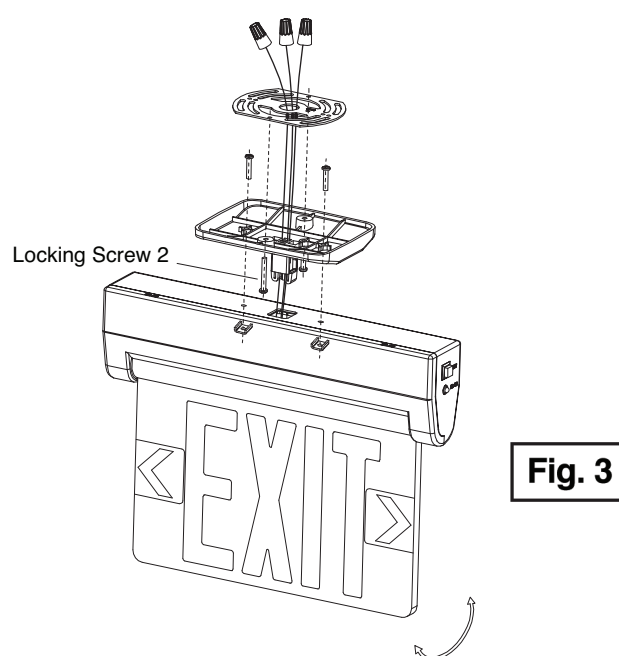
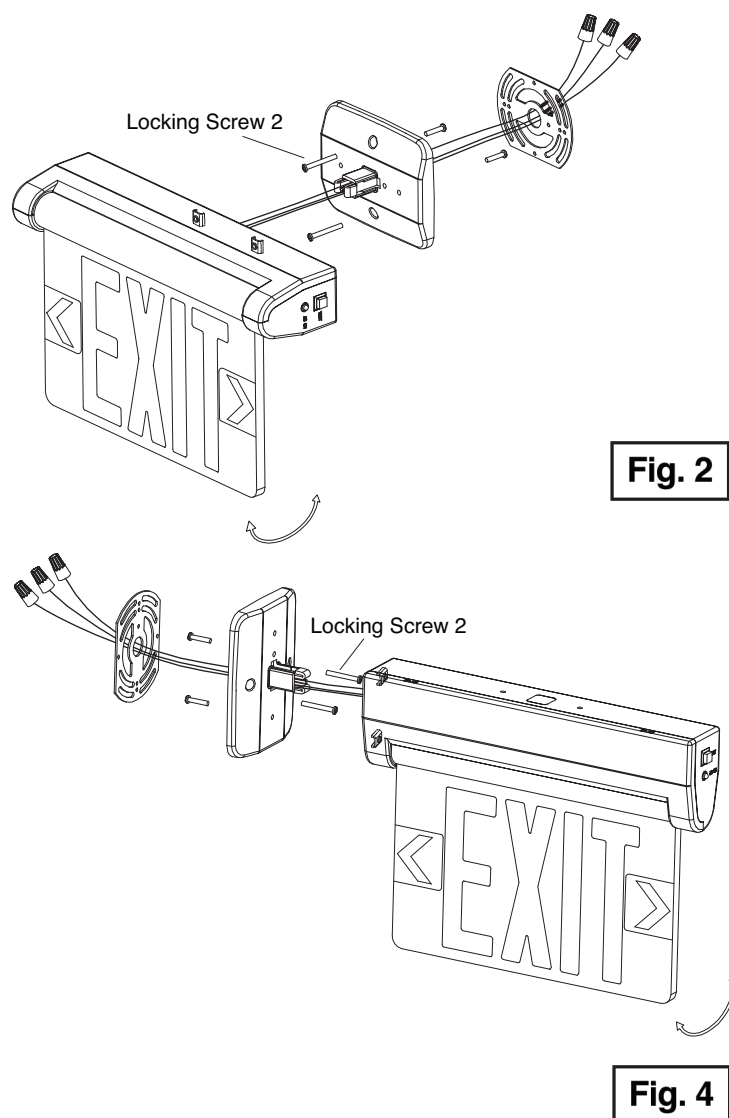

## MaxLite® Edge Lit Emergency Exit Sign



### Warranty Information

MaxLite Inc. warrants its products for a minimum period of **FIVE (5)** years from the date of original purchase from MaxLite or its authorized distributor/dealer (the "Warranty Period"), as follows: If a Product fails to operate during the Warranty Period as a result of defects in materials or workmanship, MaxLite will, at its option, repair it, replace it with the same or like Product.

Please refer to Maxlite's website (at <http://maxlite.com/resources/warranties>) for the complete terms and conditions of our warranty.

#### Limitation of Liability

THE FOREGOING WARRANTY IS EXCLUSIVE, AND IS THE SOLE REMEDY FOR ANY AND ALL CLAIMS, WHETHER IN CONTRACT, IN TORT OR OTHERWISE ARISING FROM THE FAILURE OF PRODUCT AND IS IN LIEU OF ALL OTHER WARRANTIES, EXPRESS OR IMPLIED, INCLUDING ALL WARRANTIES OF MERCHANTABILITY OR FITNESS FOR A PARTICULAR PURPOSE, WHICH WARRANTIES ARE HEREBY EXPRESSLY DISCLAIMED TO THE EXTENT PERMITTED BY LAW AND, IN ANY EVENT, SHALL BE LIMITED TO THE WARRANTY PERIOD SPECIFIED ABOVE. THE LIABILITY OF MAXLITE SHALL BE LIMITED TO THE TERMS OF THE EXPRESS WARRANTY SET FORTH HEREIN. IN NO EVENT WILL MAXLITE BE LIABLE FOR ANY SPECIAL, INCIDENTAL OR CONSEQUENTIAL DAMAGES INCLUDING, WITHOUT LIMITATION, DAMAGES RESULTING FROM LOSS OF USE, PROFITS, BUSINESS OR GOODWILL, LABOR COSTS, REMOVAL OR INSTALLATION COSTS, DECREASE IN THE LIGHT OUTPUT OF THE LAMP, AND/OR DETERIORATION IN THE LAMP'S PERFORMANCE, WHETHER OR NOT MAXLITE HAS BEEN ADVISED OF THE POSSIBILITY THEREOF. UNDER NO CIRCUMSTANCES SHALL MAXLITE'S ENTIRE LIABILITY FOR A DEFECTIVE PRODUCT EXCEED THE PURCHASE PRICE OF THAT PRODUCT. WARRANTY SERVICES PROVIDED UNDER THESE TERMS AND CONDITIONS DO NOT ENSURE THE UNINTERRUPTED OPERATION OF PRODUCTS; MAXLITE SHALL NOT BE LIABLE FOR DAMAGES CAUSED BY ANY DELAYS INVOLVING WARRANTY SERVICE.

This Limited Warranty gives you specific legal rights and you may also have other rights that may vary from state to state. Because some states or jurisdictions do not allow the exclusion or limitation of liability for consequential or incidental damages, this limitation may not apply to you.