

NF-R2

New Construction Frame-In for NM1-PRDC

Type

Project

Catalog No.

Notes

PRODUCT DESCRIPTION

New construction frame-in can be used to assist installing M1+ LED Downlight (NM1-PRDC).

Mounting: Bar hangers are adjustable from 13-¾" to 26" with integral nails. Bar hangers are slotted for T-bar ceiling grids.

COMPATIBLE LUMINAIRE

NM1-PRDC: 1" M1+ LED Downlight

PRODUCT IMAGES AND DIMENSIONS

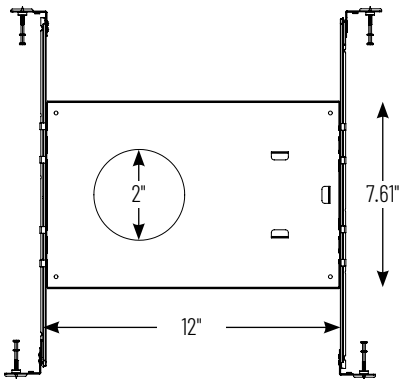

New Construction Frame-In for NM1-PRDC

Accessory Type

NF-R2 = New Construction Frame-In for NM1-PRDC

Compatible Luminaire

Description

NM1-PRDC = 1" M1+ LED Downlight

Example: NF-R2 = New Construction Frame-In for NM1-PRDC