

MODEL DISC4FL-GM-WH



WARNING

WARNING — THE INSTALLATION MUST BE CARRIED OUT BY A QUALIFIED ELECTRICIAN.

1. LED Slim Lights are suitable for indoor use only. DO NOT use outdoors
2. Please keep the LED Slim Lights away from any corrosive substance, and please use dry cloth when you clean them
3. LED Slim Lights can only be installed by a qualified electrician
4. Before installation or maintenance, please disconnect the power to prevent electric shock

Application Notice

1. For your safety, this fixture **MUST** be wired in accordance to electrical codes and ordinances
2. DO NOT open the light fixture and the side plates of driver — no serviceable part inside
3. DO NOT use any other driver except the ones advised by the supplier
4. DO NOT connect multiple fixtures to one driver

CAUTION

PLEASE READ INSTRUCTION BEFORE COMMENCING INSTALLATION AND RETAIN FOR FUTURE REFERENCES.

Electrical products can cause death or injury, or damage to property.

If in any doubt about the installation or use of this product, consult a competent electrician.

INSTALLATION GUIDE

Construction

4" floating gimbal fixtures with integral LEDs. Isolated class 2 external driver factory installed inside junction box. One driver for every fixture required. Power factor > 0.95. LED fixture and driver are TYPE IC rated, which means that it is approved for direct contact with insulation. Pot light housing is NOT required even for insulated ceilings.

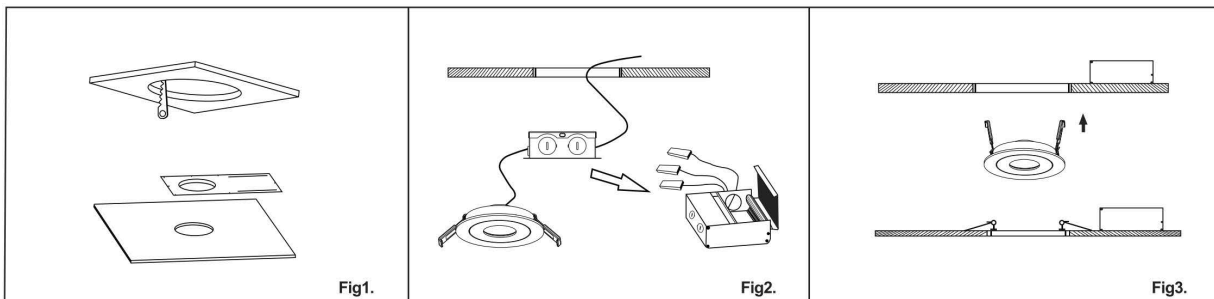

1. Cut a hole for the lamp. The plate is mounted on the board
2. Open the cover of the junction box. Push and remove one of half inch. Knockouts on the side plate. Tighten the connector by hand. DO NOT attach the junction box to anything so you can pull it through. The ceiling opening in case you need to service the driver in the future. Install standard 16 cable connector. Use double connector for daisy chaining multiple drivers. Insert line voltage feed into the cable connector and splice same colour wires using quick connector. Close the cover
3. The spring loaded into the ceiling and adjust smooth

Options for Locating Driver

1. Locate next to the fixture-run line voltage wiring to first junction box and daisy chain to the junction boxes of the fixtures
2. OR install all drivers in one location and use low voltage extension cables to the fixture. Use only extensions provided by the manufacturer. Available jumper cables are 6" (1.8m) and 20ft (6m). Cables are linkable. Maximum run should NOT exceed 40ft (12m)

Dimming: We recommend LED/CEL dimmers that have a low range adjustment dial. After all fixtures are connected to the dimmer, adjust the dial to the lowest position before the lights start to flicker or shutdown. This setting depends on the local voltage and number of fixtures per dimmer. For a typical LED dimmer rated for 150W LED, load the maximum number of fixtures per dimmer