

LED Wall Packs

MODEL WP60-3CCT+W | WP120-3CCT+W

ORTECH

Instruction Manual



WARNING

WARNING — THE INSTALLATION MUST BE CARRIED OUT BY A QUALIFIED ELECTRICIAN.

1. LED Traditional Wall Packs are suitable for using in wet, dry, and damp locations
2. Please keep the LED Traditional Wall Packs away from any corrosive substance, and please use dry or damp cloth when you clean it
3. LED Traditional Wall Packs can only be installed by a qualified electrician
4. Before installation or maintenance, please disconnect the power to prevent electric shock

Application Notice

1. Do not exceed using the standard working voltage: 100-347V AC, 50/60Hz
2. Be sure the power supply is turned off before installation
3. Switch off power of the mains supply or the connection lead respectively before doing any works
4. Please note waterproof, dustproof, electricity prevention and shockproof for the external power wires
5. Be sure the connection between the wires is in good condition when installing the lamps, beware of leakage

CAUTION

PLEASE READ INSTRUCTION BEFORE COMMENCING INSTALLATION AND RETAIN FOR FUTURE REFERENCES.

Electrical products can cause death or injury, or damage to property.

If in any doubt about the installation or use of this product, consult a competent electrician.

INSTALLATION GUIDE

1.Remove the rubber plug.

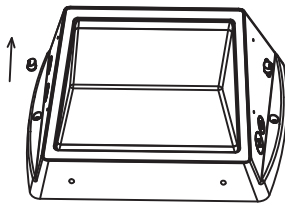

2.Remove the screws from the bottom.

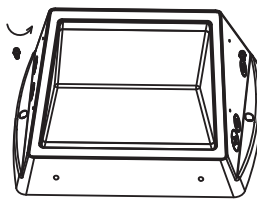

3.Remove mounting plate.

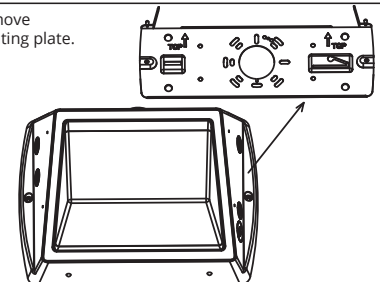

4.Fixed according to traditional installation method

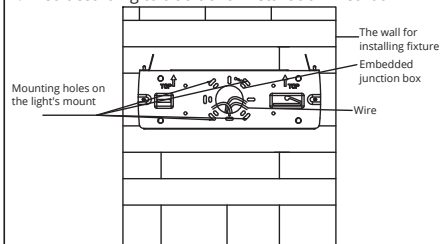

5.Hang the sling over the mounting plate.

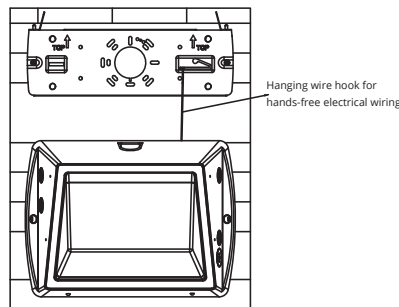

6.Connect the mains supply to the drive harness as shown in the figure, Adjust the CCT and power to the required gear.

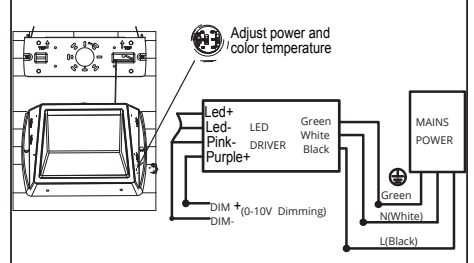

7.Buckle the lamp body onto the mounting base

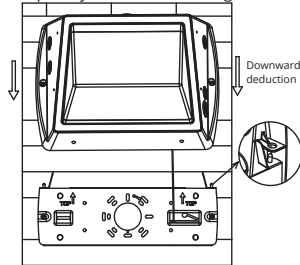

8.Install the cap screws and rubber plugs.

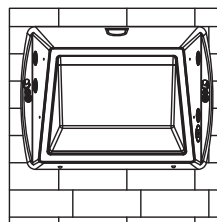

9.Fill the gap between the lamp and the wall with silicone sealant to prevent rainwater from entering the junction box.

