

# LED Emergency Lights

## MODEL OE-C212

**ORTECH**

Product Specification Sheet



### HIGHLIGHTS

- Fully Adjustable Compact LED Dual Head Emergency Light with universal J-Box mounting pattern suitable for wall mount applications
- Has 2 pieces 1W ultra bright LED lamp heads for emergency mode and 120V/277V AC dual voltage operation
- Comes with built-in 3.6V 1000mAh Nickel cadmium battery for minimum 90 minutes emergency operation
- Made of injection-molded thermoplastic ABS housing and has UL94V-0 flame rating
- Full recharge time is maximum 24 hours and is suitable for 0°C to +40°C indoor damp locations
- Includes test switch and charge indicator with more than 200 lumens
- Fast and Easy installation in minutes
- Ensures optimal 90-foot spacing when mounted at a height of 7.5 feet, delivering excellent coverage and consistent illumination
- Case Quantities: 30

### SPECIFICATIONS

Model	OE-C212
Wattage	2W
AC Voltage	120V AC /50-60Hz or 277V AC /50-60Hz
AC Charging Current	100mA AC Max.
DC Charging Voltage	4.2V DC
DC Charging Current	75mA DC Max.
Lumens	> 200 lmn
Material	Injection-molded thermoplastic ABS housing
Battery	3.6V 1000mAh
Battery Type	Nickel Cadmium Battery
Emergency Duration Time	≥ 90 min
Discharge Current	700mA ~ 900mA
Charging Time	24 hours
Colour Temp.	6016K (Cool White)
Operating Temp.	0°C ~ +40°C

DIMENSIONS

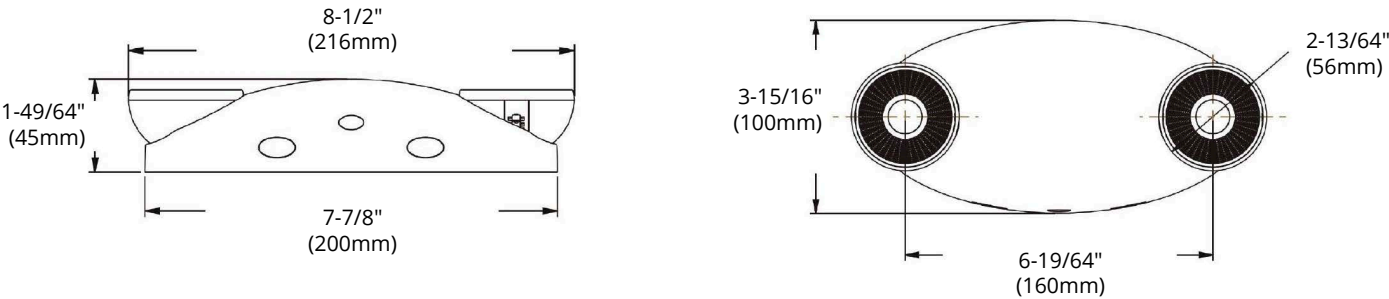

SPECTRA

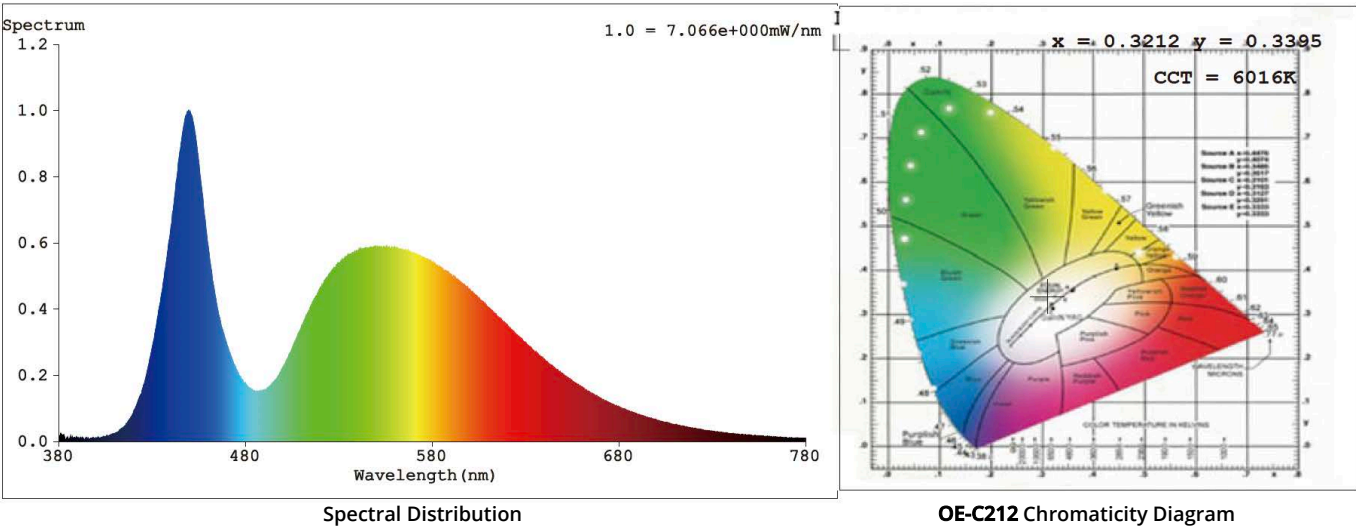

**Colorimetric Parameters**  
**Chromaticity Coordinate:** x = 0.3212 y = 0.3395 / u' = 0.1998 v' = 0.4751 (duv=4.34e-03)  
CCT= 6016K Prcp WL: Ld=498.3nm Purity=3.8%  
**Peak WL:** Lp=449nm FWHM: =25.6nm Ratio:R=12.7% G=83.4% B=3.9%

**Render Index:** Ra = 73.5

R1=71 R2=77 R3=80 R4=74 R5=72 R6=69 R7=83  
R8=62 R9=21 R10=44 R11=71 R12=44 R13=72 R14=88 R15=67

**Photometric & Radiometric Parameters**  
Flux = 246.93 lmn Eff. : 0.00 lmn/W Fe = 772.01 mW

**Electrical parameters**  
V = 0 V I = 0 A P = 0 W PF = 1.000 F=0.00 Hz

ORTECH reserves the right to modify at any time, without notice, any or all of our product's features, designs, components and specifications to meet market changes.

Reference	QTY.	Remarks	Project:
			Location:
			Architect:
			Engineer:
			Contractor:
			Submitted by:
			Date: