

# LED Slim Lights

## MODEL SLIM4BP

**ORTECH**

Product Specification Sheet



### HIGHLIGHTS

- 4" Slim LED Downlight in 9W with 4" base only box + potlight
- Multiple installation — Recessed with Can Housing and Surface Mounted with J-Box possible
- Offers perfect LED mounting with uniform light distribution without uneven shadow
- Magnet inside the interchangeable colour ring of your choice (sold separately)
- Depth is 1", and for the best possible Layout Depth Flexibility, it should be installed right under joists
- Easy and fast installation — install directly into ceiling with junction box
- IC rated for direct contact with insulation, recessed housing is not required

### MOUNTING

- The attached spring clips are for recessed housing thus cannot be installed in cut hole in ceiling
- Ceiling clearance required: 1"

### SPECIFICATIONS

Model	<b>SLIM4BP</b>
Wattage	9W
Voltage	120V
Lumens	715 lmn
Beam Angle	100°
Lifetime	50000 hours
Cutout	ø 2-13/16" (72 mm)
CRI	80
Dimmable	Yes
Rating	IC Rated / Indoor use only / for Wet location
Grade of Protection	IP 44
Air Tight	No
Applications	Drop ceilings / Office / Attics / Hallways / Bathrooms / Kitchens / Basements
Colour Temp.	3000K (Warm White) / 5000K (Cool White)
Operating Temp.	-20°C ~ +40°C
Warranty	5 years

# LED Slim Lights

## MODEL SLIM4BP

### DIMENSIONS AND TESTING REPORT

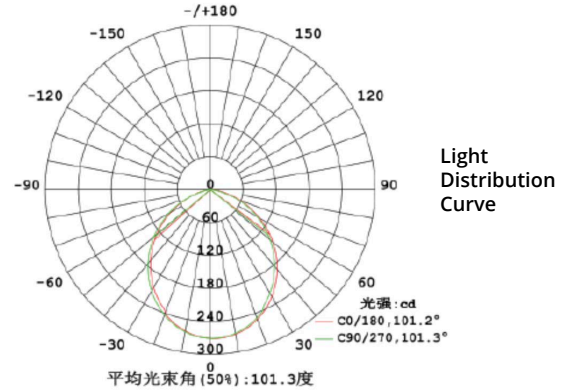
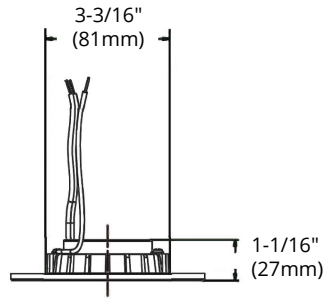
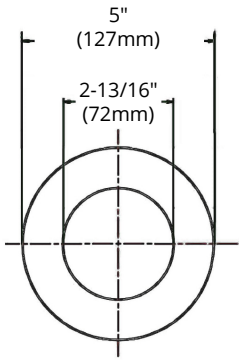

### EXPANSION FUNCTION

#### Multiple Installation possible



Recessed with Can Housing



Surface Mounted with J-Box

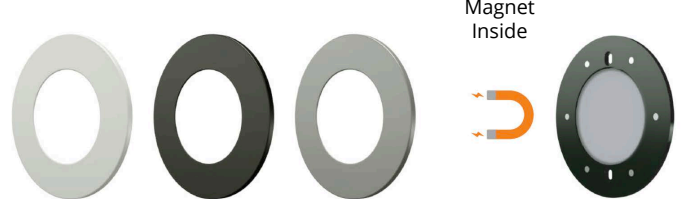

### Trims & Accessories (sold separately)



**SLIM4BP-RING WH**  
White Ring



**SLIM4BP-RING SN**  
Satin Nickel Ring



**SLIM4BP-RING CBK**  
Chrome Black Ring



**SLIM4BP-RING BK**  
Black Ring



**DMD-ELV**  
Single pole 3-way dimmers

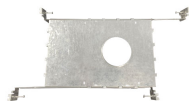

**PLATE4-HB**  
Mounting Plates for  
ORTECH 4 inch Slim Lights



**PLATE26-4**  
New Construction Plates  
for ORTECH 4 inch Slim Lights



E26 base and Metal Plate

Reference	QTY.	Remarks	Project:
			Location:
			Architect:
			Engineer:
			Contractor:
			Submitted by:
			Date:

ORTECH reserves the right to modify at any time, without notice, any or all of our product's features, designs, components and specifications to meet market changes.