

### Tools Required

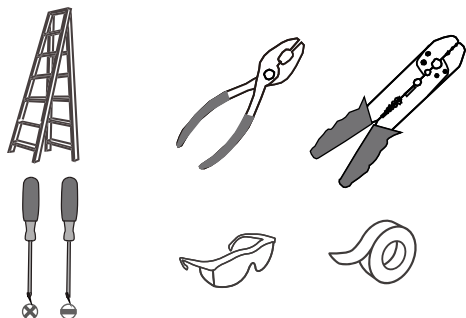

### Light Source

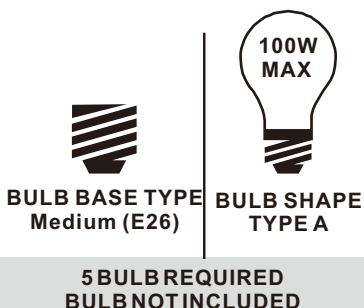

### Fixture Height Adjustable 18" to 48"

#### ⚠ Warnings and Cautions

Turn off the electricity at the circuit breaker before installation. Consult a licensed electrician if in doubt about installation.

Turn off power to the fixture and allow the bulbs to cool before replacing.

### Package Contents

**Preparation:** Identify and inspect all parts before beginning the installation.

Missing or damaged parts? Contact your original place of purchase.

#### PARTS BAG

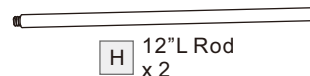
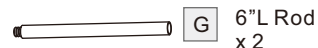
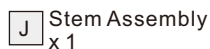
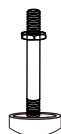
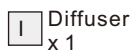
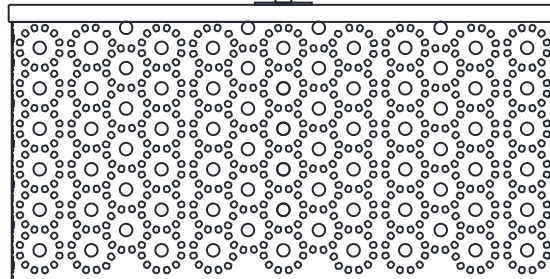
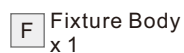
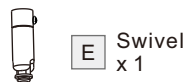
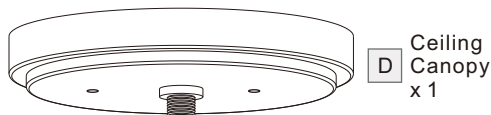
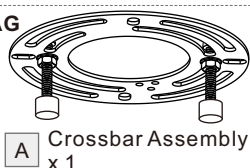

### Table of Contents

#### Crossbar Assembly

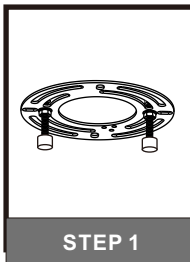

STEP 1

#### Downrod

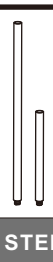

STEP 2

#### Lanyard

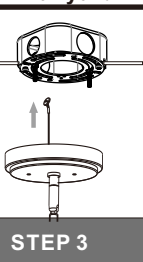

STEP 3

#### Wiring

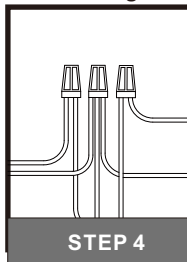

STEP 4

#### Ceiling Canopy

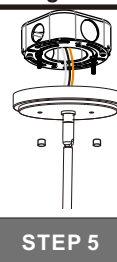

STEP 5

#### Bulb and Diffuser



STEP 6

## STEP 1

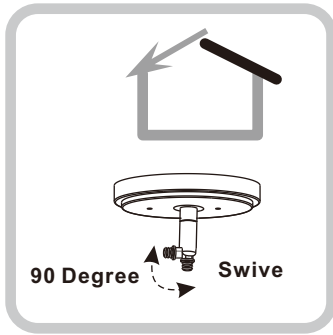

For angled ceilings,  
Swivel opening towards wall.

### 1 Step 1 Install crossbar assembly

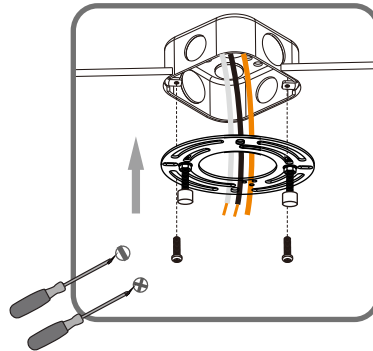

### 2 Step 2 - 3 Test fitting ceiling canopy to mounting screws

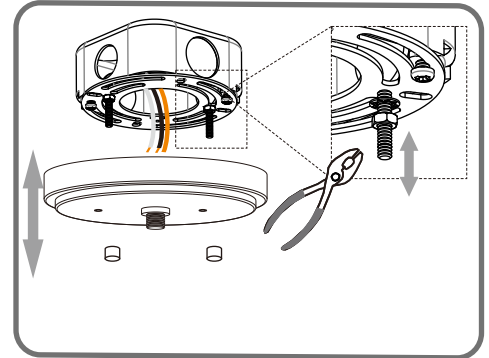
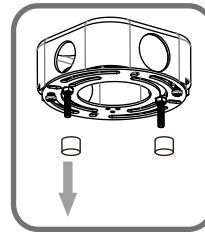

## STEP 2

### Optional Rods

**8' ceiling:**  
(2) 6"L + (1) 12"L  
rods  
**9' ceiling:**  
(2) 6"L + (2) 12"L  
rods

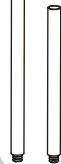

1

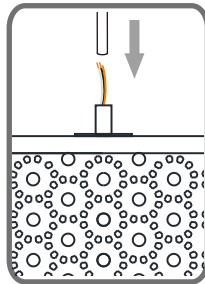

2

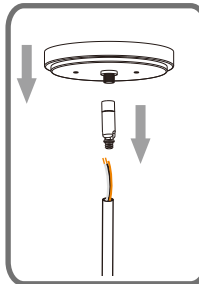

3

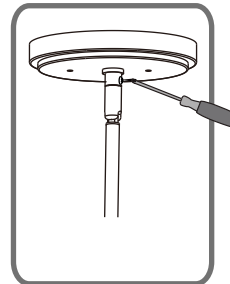

### OPTION 1

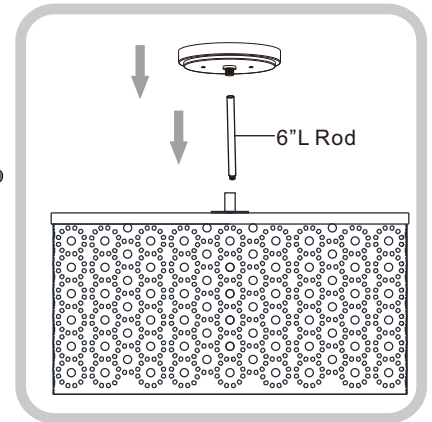

### OPTION 2

## STEP 3

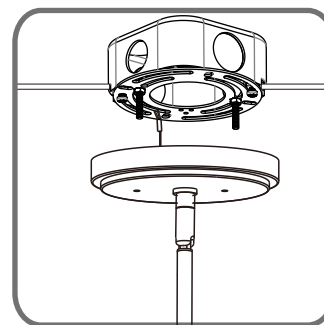
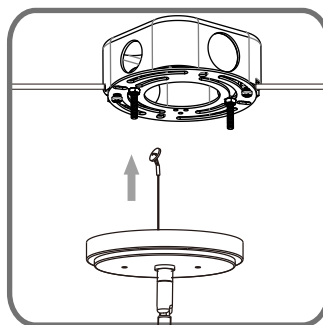

## STEP 4

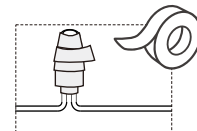
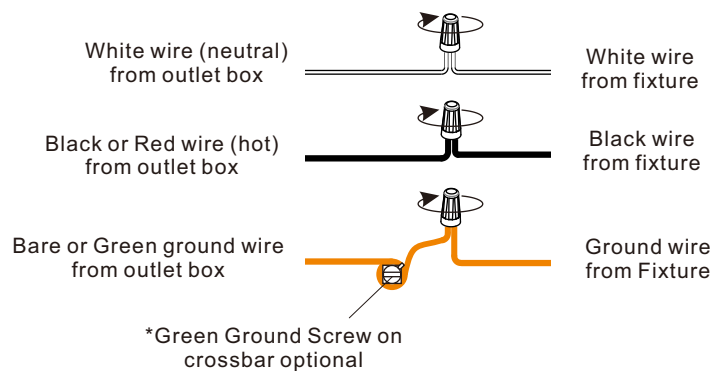

**STEP 5**

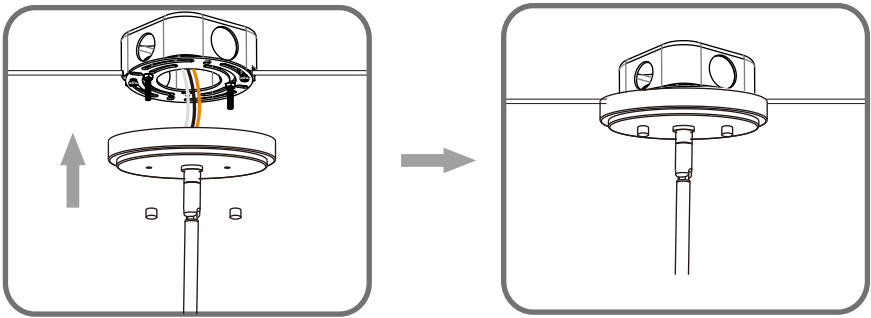

**STEP 6**

