

## Dual Heads LED Emergency Light



### Features:

- Injection-molded thermoplastic ABS housing, UL 94V-0 flame rating
- Innovative, easy installation in minutes
- Suitable for wall mount applications
- Universal J-box mounting pattern
- 120/347VAC Dual Voltage operation
- 2pcs 1W ultra bright LED lamp heads for emergency mode
- Luminous Flux: more than 200 LM
- Built-in 3.6V 1000mAh Nickel cadmium battery for minimum 90 minutes emergency operation
- Maximum 24 hours for full recharge time
- Test switch and charge indicator
- UL and CULus listed
- 32°F (0°C) to 104°F (40°C) indoor damp location listed
- Five years warranty for the electrical parts and housing
- Three years warranty for battery

### Specification

|                           |                                  |
|---------------------------|----------------------------------|
| Model No.                 | JLEU10                           |
| Charging Time             | 24h                              |
| AC Voltage                | 120V/347V 50-60Hz                |
| AC Charging Current (MAX) | 100mA                            |
| DC Charging Voltage       | 4.2V                             |
| DC Charging Current (MAX) | 75mA                             |
| Distance Time             | ≥90mins                          |
| Discharge Current         | 700mA-900mA                      |
| Luminous Flux             | ≥200LM                           |
| Color Temperature         | 6000K-7000K                      |
| Packing Information       | 14"x9.65"x10.2"6pcs 4.62/3.45kgs |

### Dimensions:

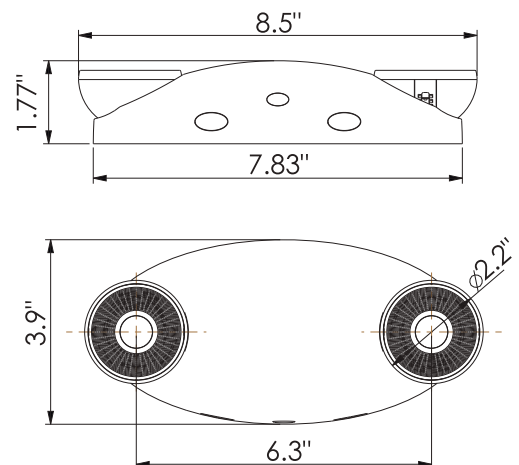

No Glare

Efficient Thermal  
Dissipation

Instant On

No Flicker